

INFRALITE® 60: Recessed Motorized Birthing Lights



Ohio State University Medical Center, Doan Hall
Columbus, Ohio
Lighting: **RS01704 - INFRALITE® 60**
Also shown: **RR90722 - ShatterGuard Downlights**

Features:

- Lights are fully recessed, providing an unobstructed ceiling with regressed smooth trim design which complements room decor and enables quick, effective housekeeping.
- 60° illumination delivers light at low angle for superior birthing canal illumination, eliminating the need for portable or drop down ceiling lights.
- Patented lighting system provides instantaneous, precise direction and intensity of light. Both remote and wall controls are single-handed use with convenient tactile membrane switches.
- Dichroic (cold mirrored) reflectors transmit 70% less heat, assuring patient and clinician comfort.
- Two lamps in each fixture, with two fixtures per system, provide intensities up to 7800 fcs with shadowless, uniform pattern.
- 100 CRI tungsten halogen lamps yield accurate color rendering of tissue for accurate diagnosis.
- All service is through the light aperture and all components are modular for fast and simple service. Relamping is quick and easy.

THE **KIRLIN** COMPANY

3401 East Jefferson Avenue • Detroit, MI 48207-4232
313-259-6400 • FAX 313-259-3121 • info@kirlinlighting.com • www.kirlinlighting.com

Recessed Motorized Procedural Lights

For more information, including specification sheets and photometry, on these and all other Kirlin products, please visit www.kirlinlighting.com or call your local Kirlin Sales Representative for the **Healthcare Facility & Patient Lighting catalog (03HC)**.

INFRALITE® DX



Features (per luminaire)

- Tilt up to 35°
- 360° horizontal adjustability
- 250W 22 volt TH DCB T4 lamp
- Cold mirrored reflector
- RR01200 - two luminaire system
- RR01201 - one luminaire system

Performance

25,600 fcs/pair
Ceiling height: 8 ft
Luminaire spacing: 4 ft

Dimensions

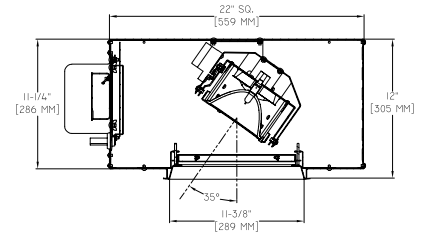

INFRALITE®



- Tilt up to 35°
- 360° horizontal adjustability
- 150W 22 volt TH DCB T4 lamp
- Cold mirrored reflector
- RR01202 - two luminaire system
- RR01203 - one luminaire system

18,100 fcs/pair
Ceiling height: 8 ft
Luminaire spacing: 4 ft

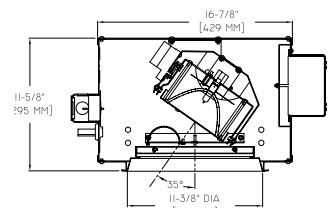

INFRALITE® 60

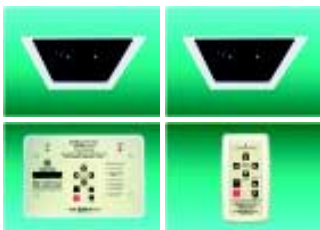

- Tilt up to 60° (ideal for LDRs)
- 45° horizontal adjustability
- 2-150W 22 volt TH DCB T4 lamps
- 2 cold mirrored reflectors
- RS01704 - two luminaire system

7800 fcs/pair
Ceiling height: 8 ft
Setback from target: 6 ft
Luminaire spacing: 4 ft

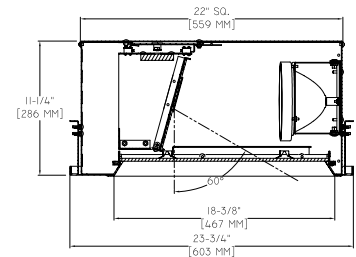

OPTILITE™



- Tilt up to 35°
- 360° horizontal adjustability
- 150W 120 volt TH DCB T4 lamp
- Cold mirrored reflector
- RR01206 - two luminaire system
- RR01207 - one luminaire system
- RR01208 - one luminaire system (linear sweep)

4900 fcs/pair
Ceiling height: 8 ft
Luminaire spacing: 4 ft

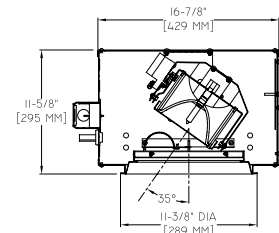

SPOTLITE™



- Tilt up to 35°
- 360° horizontal adjustability
- 250W 120 volt TH PAR38 lamp
- RR01209 - two luminaire system
- RR01210 - one luminaire system
- RR01211 - one luminaire system (linear sweep)

3300 fcs/pair
Ceiling height: 8 ft
Luminaire spacing: 4 ft

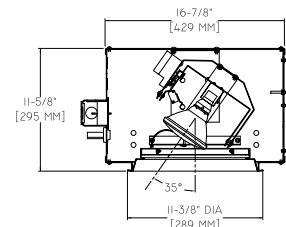

THE KIRLIN COMPANY

3401 East Jefferson Avenue • Detroit, MI 48207-4232
313-259-6400 • FAX 313-259-3121 • info@kirlinlighting.com • www.kirlinlighting.com